

AIRTIGHT CIRCULAR VOLUME CONTROL DAMPER

RCE

Circular damper **RCE** is designed to shut off circular ventilation ductworks (Class 4C according to EN1751) in stainless steel 316L. It is suitable for clean room HVAC applications (laboratories, hospitals...).



ÉQUILIBRAGE

CODIFICATION

RC —> **RC range** - Circular damper

X —> **E** - Airtight class 4

CONSTRUCTION

Casing
Stainless steel 316 L
EPDM gasket on blade to ensure an upstream-downstream class 4 airtightness according to EN1751
Male connection with EPDM gasket to ensure frame's airtightness class C according to EN 1751

Blade
Stainless steel 316 L

COMMANDES

manual/suitable for actuator control (Control shaft 8 mm square)	Motorized damper
	Electrical actuator

PERFORMANCES

	RCE
Downstream airtightness (EN 1751)	Class 4
Frame's airtightness (EN 1751)	Class C
Acceptable pressure	1000 Pa
Acceptable velocity	12 m/s
Operating temperature	From -20°C to +70°C
Atex	Zone : 1 ; 2 ; 21 ; 22 Temperature class : T6

AIRTIGHT CIRCULAR VOLUME CONTROL DAMPER

RCE

DIMENSIONS AND RECOMMENDED TORQUES

Ø (mm)	L (mm)	L ₁ (mm)	R1 (mm)	Weight manual RCE (kg)	Torque (Nm)
100	200	100	-50	1	2
125	200	100	-37.5	1.1	2
160	200	100	-20	1.3	2
200	200	100	0	1.5	2
250	200	100	25	2.1	4
315	300	150	7.5	3.7	4
355	300	150	27.5	4.2	8
400	300	150	50	6.1	8
450	400	200	25	8.1	8
500	400	200	50	9.3	8
560	400	200	80	10.8	8
630	400	200	115	12.7	8

RCE manual

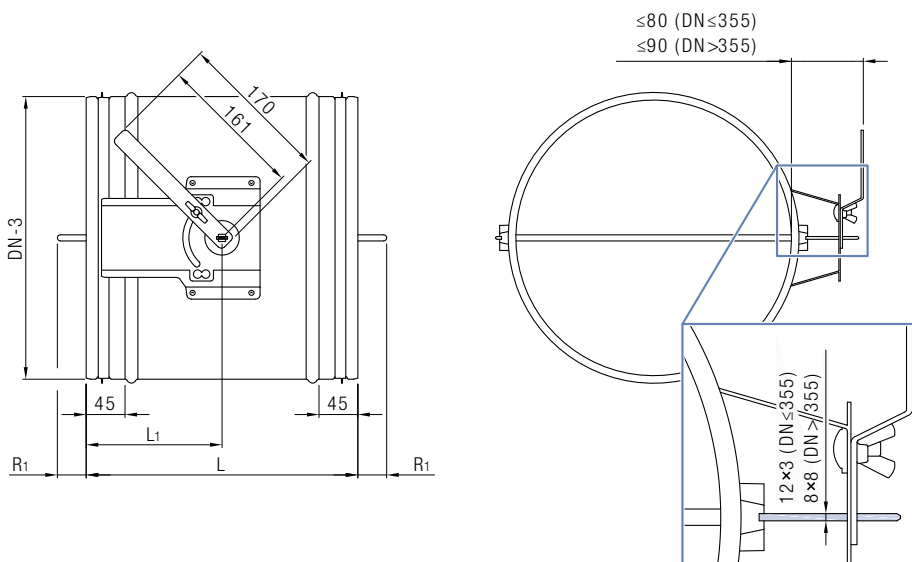

Dimensions in mm